

## TERMINAL BLOCKS

- 3.81mm Pitch
- Professional rising clamp
- 2 - 12 pole interlocking
- 0.75mm<sup>2</sup> wire acceptance
- UL/CE approved
- Colour green

## 3.81MM PITCH ULTRA LOW PROFILE

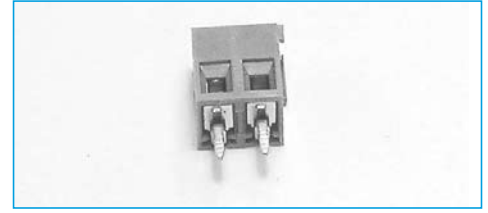

## SPECIFICATION

### Electrical Characteristics

**Rating Current:** 9A/130Vac  
**Contact Resistance:** 1.5kV/60sec  
**Insulation Resistance:** ≥ 5MΩ  
**Operating Temperature:** -20°C to +125°C  
**Short Period:** 160°C

**Moulding:** UL94-V0 flame retardant PA66  
**Pin/terminal:** 5μ tinned, nickel plated brass  
**Rising clamp:** Nickel Plated brass  
**Screw/torque:** M2 steel, 6μ zinc colour passivated and tropicalised/0.3Nm  
**Recommended PCB hole size:** ø1.1mm

## OUTLINE DRAWING

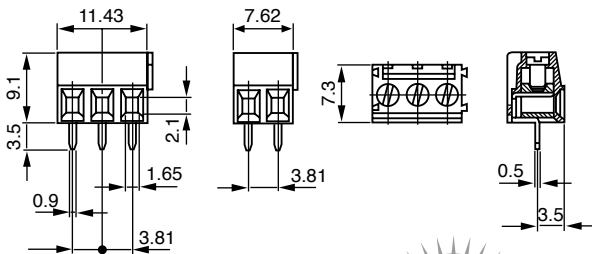

## ORDERING INFORMATION

| DBC                 | TB                     | 40    | /2  |
|---------------------|------------------------|-------|---|
| Dubilier Connectors | Series Terminal Blocks | Style | No of Ways<br>2 = 2ways<br>3 = 3ways  |
|                     |                        |       | * other number of ways are available<br>Please consult the office for further details |

## TERMINAL BLOCKS

- 3.81mm Pitch
- Ultra Low Profile
- Flame Retardant Material
- 0.75mm<sup>2</sup> wire acceptance
- UL/ CSA approved
- Interlocking
- Professional rising clamp



## 3.81mm PITCH 90° MOUNT



## SPECIFICATION

**Rating:** 9A/130V  
**Dielectric Strength:** 1.5KV/60sec  
**Insulation Resistance:** ≥5MΩ  
**Working temperature:** -20°C to 125°C  
**Short Period:** 160°  
**Moulding:** UL94V-0 flame retardant PA66

**Pin/terminal:** 5μ tinned, nickel plated brass  
**Wire protector:** Nickel plated brass  
**Screw/torque:** M2 steel, 6μ zinc colour passivated and tropicalised/0.3Nm  
**Recommended PCB hole size:** ø1.1mm

## OUTLINE DRAWING

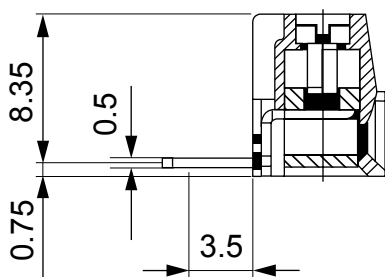

## ORDERING INFORMATION

| DBC                 | TB                    | 83    | /2   |
|---------------------|-----------------------|-------|--|
| Dubilier Connectors | Series Terminal Block | Style | N° of Ways<br>2 = 2 ways<br>3 = 3 ways   |
|                     |                       |       | * Other Number of ways are available up to 12<br>Please consult office for further details |



**TERMINAL BLOCKS**

**3.81mm PITCH PLUG IN**

- 3.81mm Pitch
- UL/ CE approved
- Flame Retardant Material
- Closed end headers
- 1mm<sup>2</sup> wire acceptance
- Professional rising clamp

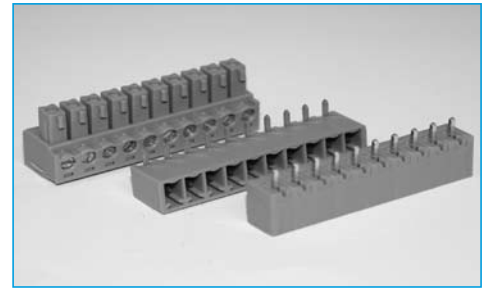

**SPECIFICATION**

|                               |                              |                                   |   |
|-------------------------------|------------------------------|-----------------------------------|---|
| <b>Rating:</b>                | 9A/130V                      | <b>Pin/terminal:</b>              | 5μ tinned, phosphor bronze                                  |
| <b>Dielectric Strength:</b>   | ≥1.25KV/60sec                | <b>Rising clamp:</b>              | 5μ Nickel copper flash brass                                |
| <b>Insulation Resistance:</b> | ≥5MΩ                         | <b>Screw/torque:</b>              | M2 steel, 6μ zinc, colour passivated and tropicalised/0.4Nm |
| <b>Working temperature:</b>   | -20°C to 125°C               | <b>Recommended PCB hole size:</b> | ø1.0mm  |
| <b>Short Period:</b>          | 160°                         |                                   |   |
| <b>Moulding:</b>              | UL94V-0 flame retardant PA66 |                                   |   |

**OUTLINE DRAWING**

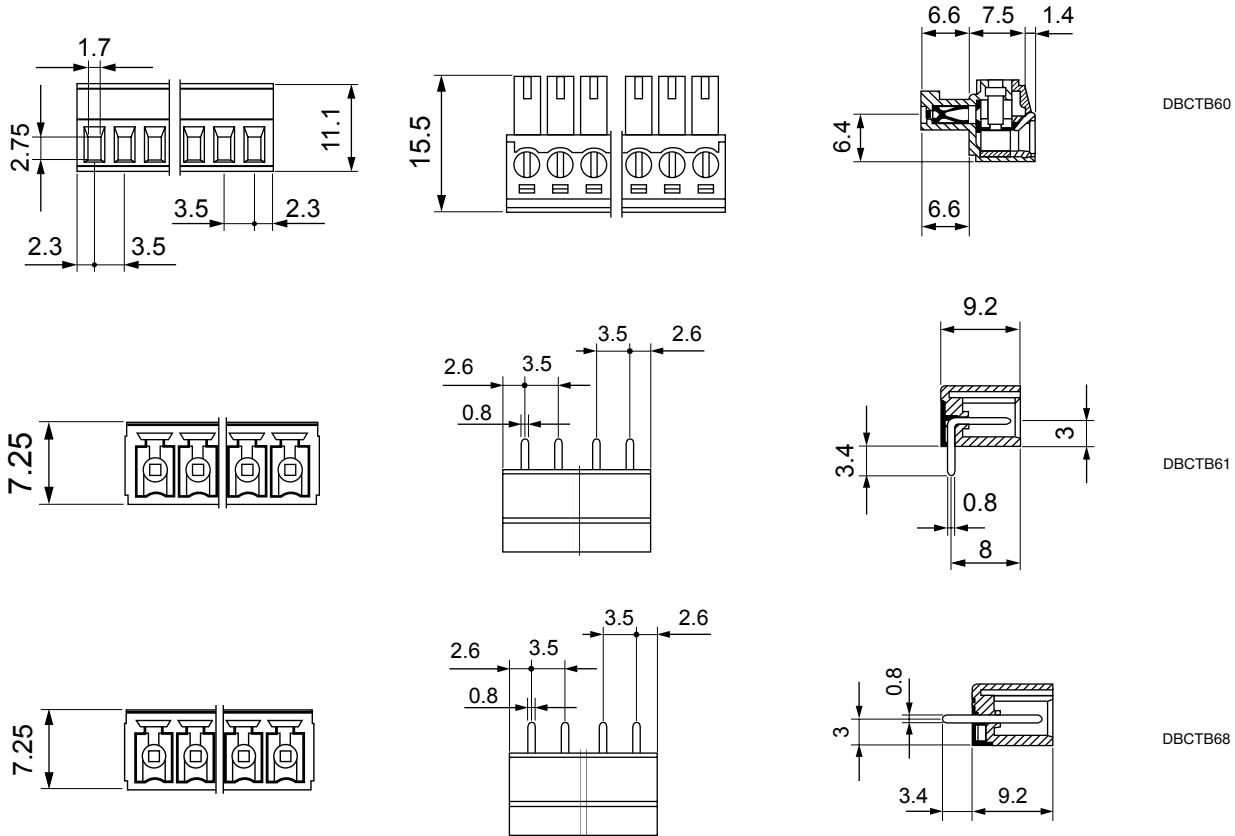

**ORDERING INFORMATION**

SECTION 18

| DBC  | TB                    | 60          | /2         |
|--|-----------------------|-------------|------------|
| Dubilier Connectors  | Series Terminal Block | Style       | N° of Ways |
|  |                       | 60=Style 60 | 2 = 2 ways |
|  |                       | 68=Style 68 | 3 = 3 ways |
|  |                       | 61=Style 61 |            |
| * Other Number of ways are available up to 12<br>Please consult office for further details |                       |             |            |