

**FUSEHOLDER**

**PCB MOUNTING 5x20mm FUSEHOLDER**

- PCB board mounting
- Kinked pin for PCB retention
- Transparent insulation cover (order separately) - DBCFH4

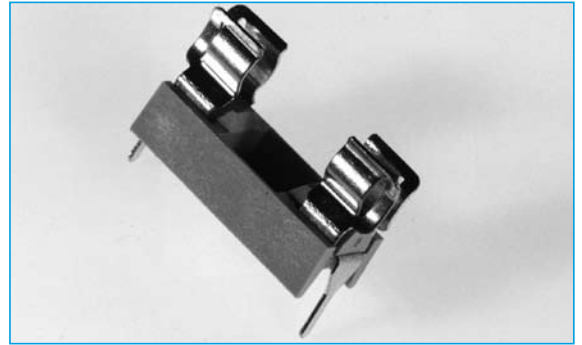

**SPECIFICATION**

**Rating:** 10A / 250V  
**Contacts/Resistance:** Tinned Nickel plated Brass/<5mΩ  
**Moulding:** UL94-V1 self extinguishing PPOM  
**Insulation Resistance:** >10<sup>2</sup>MΩ  
**Power dissipation:** 1.6W  
**Recommended PCB hole size:** 1.3mm  
**Approvals:** CE, SEMKO, VDE, UL

**OUTLINE DRAWING**

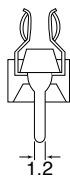
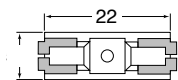
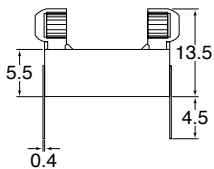

**DBC FH 3**

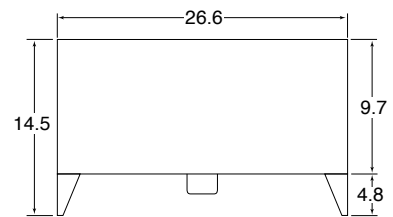
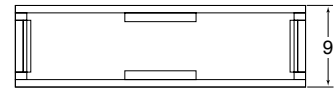

**DBC FH 4**

**ORDERING INFORMATION**

DBC	FH	3
Dubilier Connectors	Series	Style
	Fuse Holder	3
	Fuse Holder Cover	4

SECTION 13

**FUSEHOLDER**

**PCB MOUNTING 5x20mm FUSEHOLDER**

- PC board mounting
- Fuse retaining insulation cover DBCFH5 for DBCFH6
- Enclosed contacts
- 22.6mm pitch
- Black

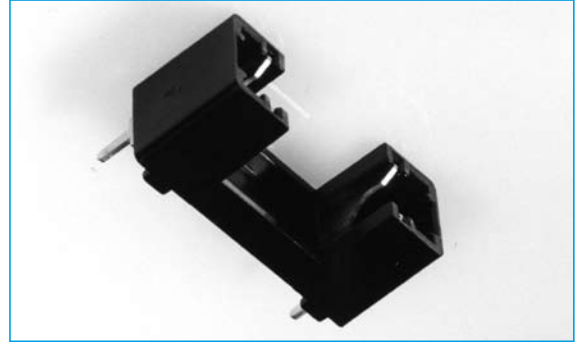

**SPECIFICATION**

**Rating:** 6.3A / 250V  
**Contacts/Resistance:** Tinned Nickel plated Brass/5mΩ  
**Material:** UL94-V0 flame retardant  
**Insulation Resistance:** >10<sup>2</sup>MΩ  
**Power dissipation:** 1.6W  
**Recommended PCB hole size:** 1.5mm  
**Approvals:** CE, SEMKO, VDE

**OUTLINE DRAWING**

SECTION 13

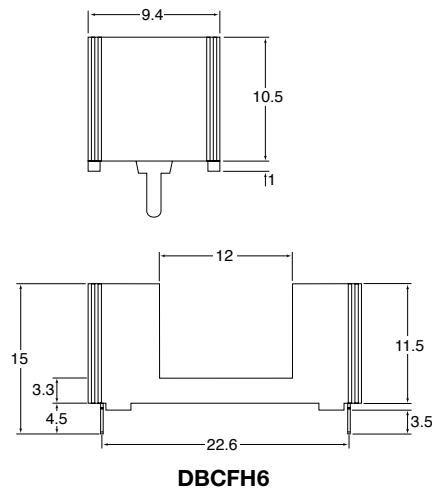
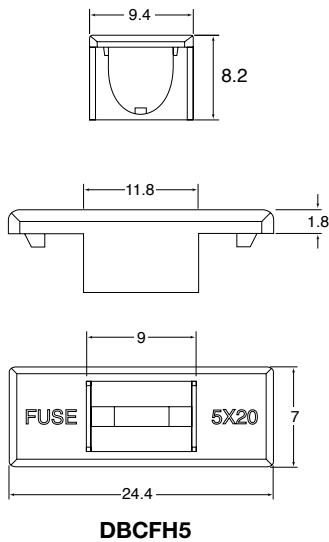

**ORDERING INFORMATION**

DBC	FH	5
Dubilier Connectors	Series	Style
	Fuse Holders Cover	5
	Fuse Holders	6

**FUSEHOLDERS**

**PCB MOUNTING 5x20mm**

- Finger / screwdriver release bayonet carrier
- Horizontal or vertical mounting
- 10mm pitch centres

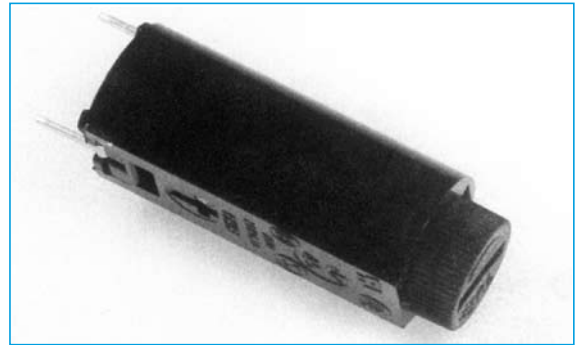

**SPECIFICATION**

**Rating:** 6.3A / 250V  
**Contacts/Resistance:** Tinned Nickel plated Brass/<5mΩ  
**Insulation Resistance:** >10<sup>2</sup>MΩ  
**Mouldings:** UL94- V0 flame retardant polyamide  
**Power dissipation:** 2.5W  
**Recommended PCB hole size:** 1.3mm  
**Approvals:** SEMKO, UL, CSA, CE, VDE

**OUTLINE DRAWING**

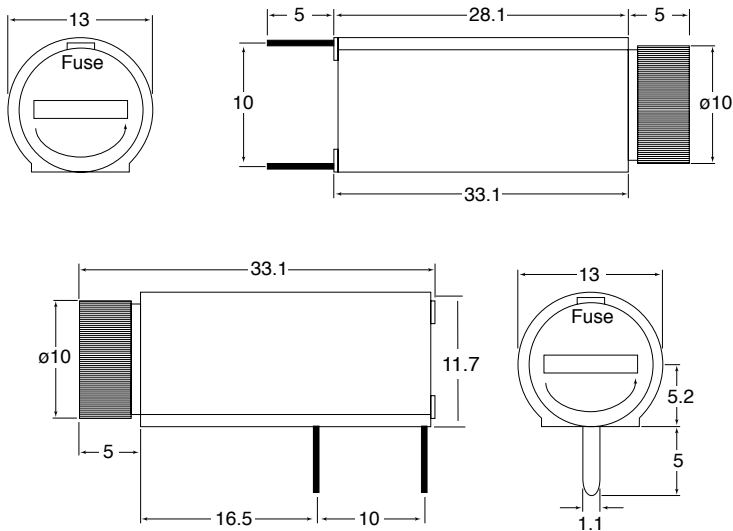

**DBCFH7**

**DBCFH8**

**ORDERING INFORMATION**

DBC	FH	7
Dubilier Connectors	Series	Style
	Fuse Holder	7
	Fuse Holder	8

SECTION 13